

Revisions			
Rev	Description	Date	Approved:
A	Initial Release	2015.10.28	A. M

**ELECTRICAL PERFORMANCE**  
 1. Frequency Range: 5.4-8.1 GHz  
 2. VSWR: 1.20 max.  
 3. Load Power: 250 W  
 4. WG Type: WR137

**MATERIAL**  
 1. Body: Brass

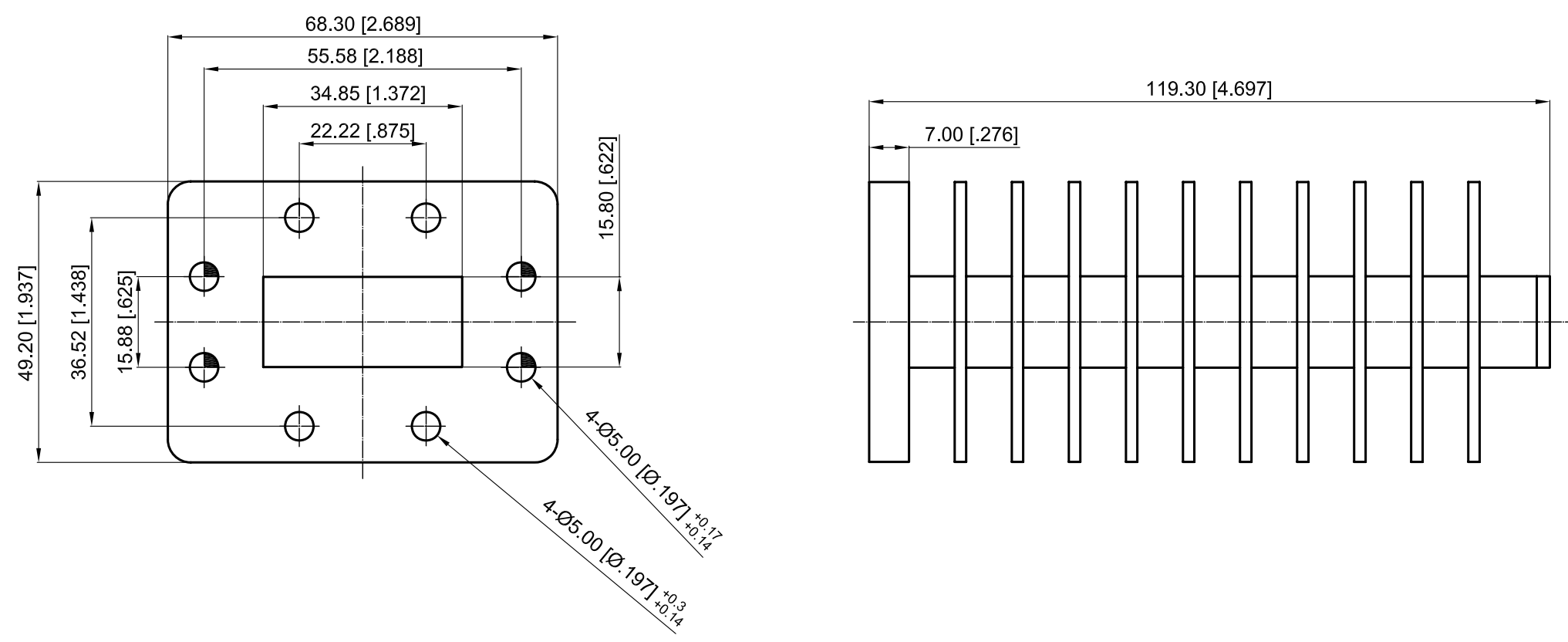

**NOTES:**  
 1. ALL SPECIFICATIONS ARE SUBJECT TO CHANGE WITHOUT NOTICE AT ANY TIME  
 2. CUSTOMER OUTLINE DRAWING FOR REFERENCE ONLY

Drawn:	W. Y 2015.10.28
Checked:	T. L 2015.10.28
Approved:	A. M 2015.10.28
Unless Otherwise Specified Dimensions are in Millimeters, Dimensions in [ ] are in Inches for Customer Reference Only. Unless Otherwise Specified Tolerance are: .XX ±0.13 [.005"] .X ±0.20 [.008"] X ±0.50 [.019"] .X° ±1° X° ±2°	

Title:	<b>WR137 Load, 250W</b>
Part No:	<b>DWL137-250</b>

**DEEWAVE**  
[www.deewave.com](http://www.deewave.com)

View:

Size: A3	Scale: 1:1	Sheet: 1/1	Rev: A
----------	------------	------------	--------