

ELECTRICAL SPECIFICATIONS

Frequency Range: 320-330 MHz
 Impedance: 50 Ohm
 Insertion Loss: 0.3 dB max.
 Isolation: 23 dB min.
 VSWR: 1.20 max.
 Forward Power: 100W
 Director: Clockwise
 Operation Temp.: -30~+75 °C

Revisions			
Rev	Description	Date	Approved:
A	Initial Release	2019.6.20	A. M

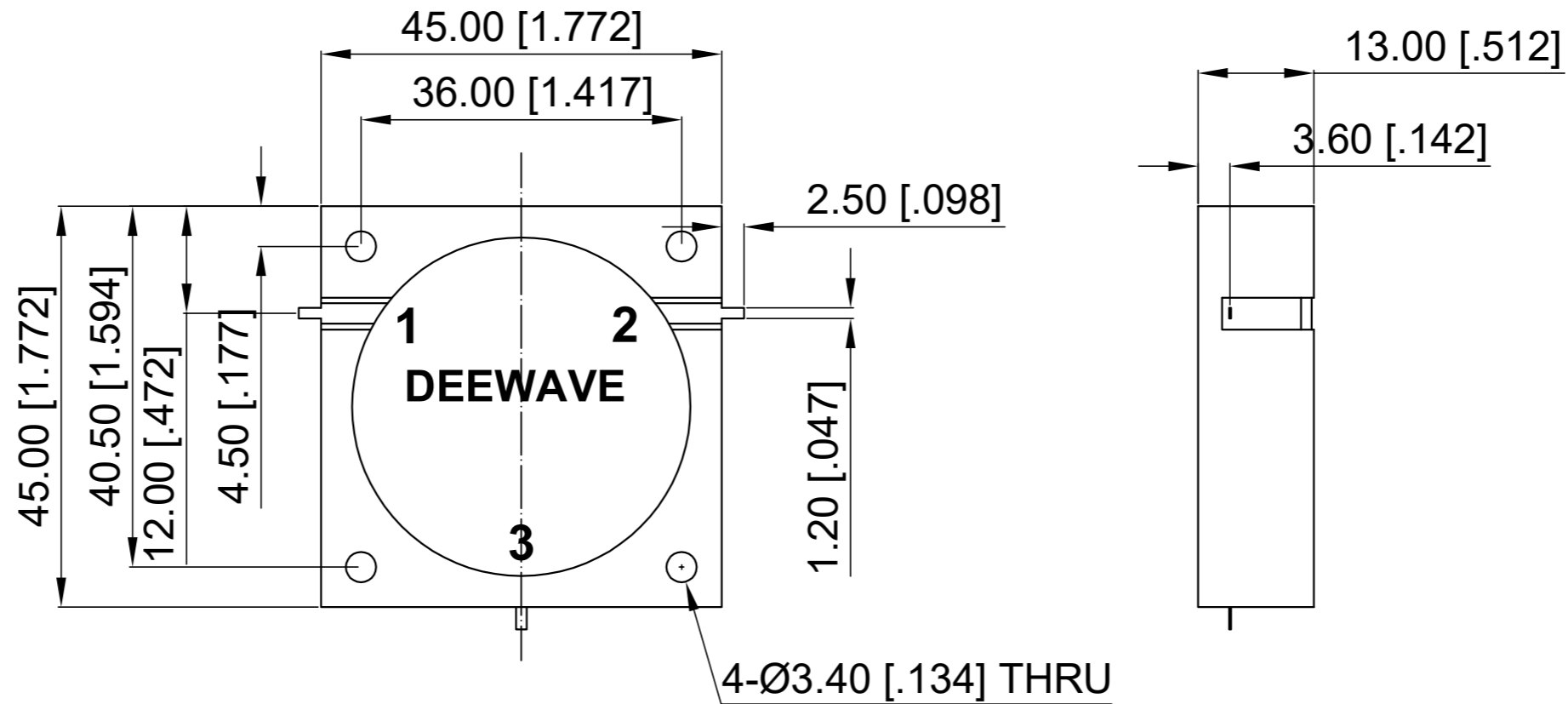

- NOTES:
1. ALL SPECIFICATIONS ARE SUBJECT TO CHANGE WITHOUT NOTICE AT ANY TIME
 2. CUSTOMER OUTLINE DRAWING FOR REFERENCE ONLY

Drawn:	W. Y 2019.6.20
Checked:	T. L 2019.6.20
Approved:	A. M 2019.6.20
Unless Otherwise Specified Dimensions are in Millimeters, Dimensions in [] are in Inches for Customer Reference Only. Unless Otherwise Specified Tolerance are: .XX ±0.13 [.005"] .X ±0.20 [.008"] X ±0.50 [.019"] .X° ±1° X° ±2°	

Title:	Drop-in Circulator Freq 320-330 MHz
Part No:	DDC032033

DEEWAVE
www.deewave.com

View:

Size:	Scale:	Sheet:	Rev:
A3	2:1	1/1	A