

## Performance Features

Nominal Impedance: 50Ω

Frequency Range: DC-33 GHz

Durability: 500 Cycles

Operating Temperature: -55°C~+165°C

## Materials/Finishes

Housing: Type 303 Stainless Steel - Polished & Passivated

Center Contact: Beryllium Copper Plated Gold

Insulators: PEI

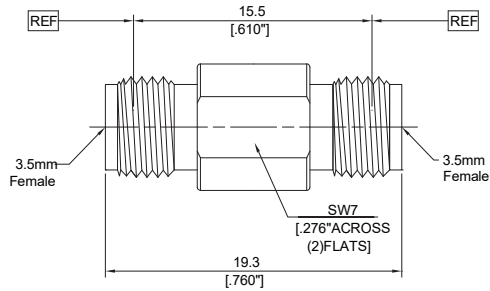

P/N	DPA24024001
Descr.	3.5mm F to 3.5mm F
Freq.	DC-33GHz
VSWR	1.15:1(Max)

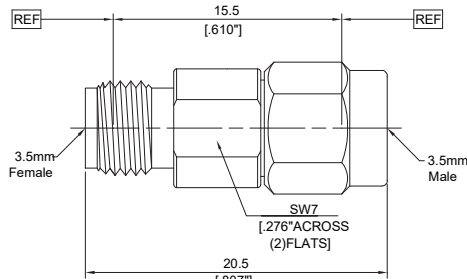

P/N	DPA24024102
Descr.	3.5mm F to 3.5mm M
Freq.	DC-33GHz
VSWR	1.15:1(Max)

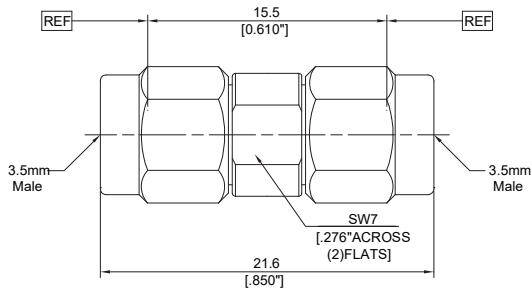

P/N	DPA24124103
Descr.	3.5mm Male to 3.5mm Male
Freq.	DC-33GHz
VSWR	1.15:1(Max)

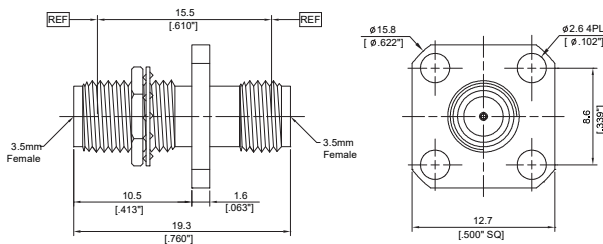

P/N	DPA24024004
Descr.	3.5mm F to 3.5mm F, Flange
Freq.	DC-33GHz
VSWR	1.15:1(Max)

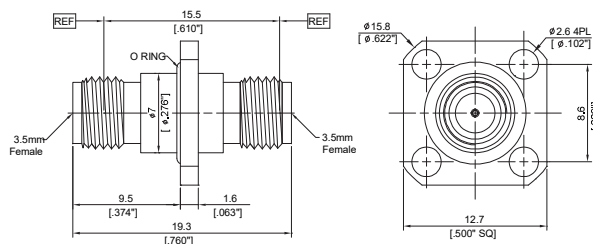

P/N	DPA24024005
Descr.	3.5mm F to 3.5mm F, Flange
Freq.	DC-33GHz
VSWR	1.15:1(Max)

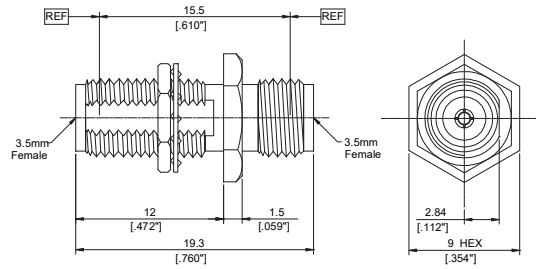

P/N	DPA24024006
Descr.	3.5mm F to 3.5mm F, Bulkhead
Freq.	DC-33GHz
VSWR	1.15:1(Max)

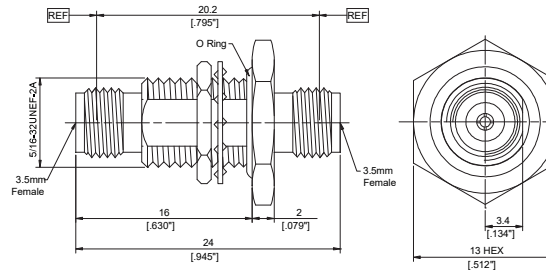

P/N	DPA24024007
Descr.	3.5mm F to 3.5mm F, Bulkhead
Freq.	DC-33GHz
VSWR	1.15:1(Max)

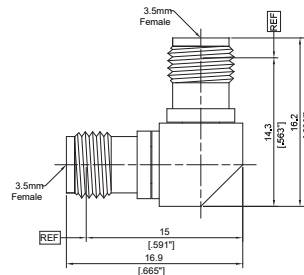

P/N	DPA24024008
Descr.	3.5mm F RA to 3.5mm F
Freq.	DC-33GHz
VSWR	1.25:1(Max)

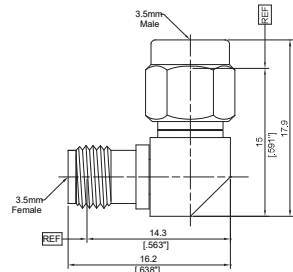

P/N	DPA24024109
Descr.	3.5mm F RA to 3.5mm M
Freq.	DC-33GHz
VSWR	1.25:1(Max)

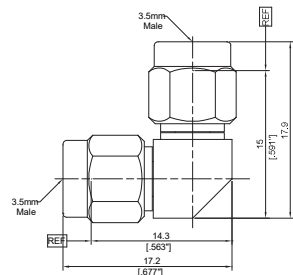
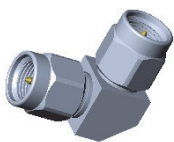

P/N	DPA24124110
Descr.	3.5mm M RA to 3.5mm M
Freq.	DC-33GHz
VSWR	1.25:1(Max)