

### Performance Features

Nominal Impedance: 50Ω

Frequency Range: DC-18 GHz

Durability: 500 Cycles

Operating Temperature: -55°C~+165°C

### Materials/Finishes

Housing: Type 303 Stainless Steel - Polished & Passivated

Center Contact: Beryllium Copper Plated Gold

Insulators: PEI&PTFE

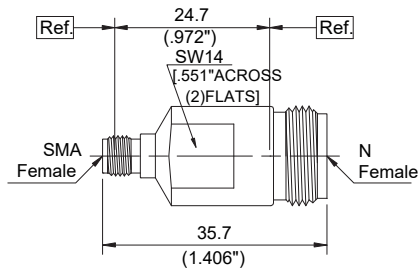

|        |                        |
|--------|------------------------|
| P/N    | DPA28025001            |
| Descr. | N Female to SMA Female |
| Freq.  | DC-18GHz               |
| VSWR   | 1.15:1(Max)            |

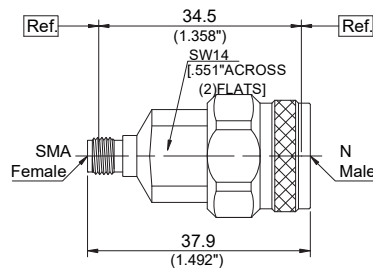

|        |                      |
|--------|----------------------|
| P/N    | DPA28125002          |
| Descr. | N Male to SMA Female |
| Freq.  | DC-18GHz             |
| VSWR   | 1.15:1(Max)          |

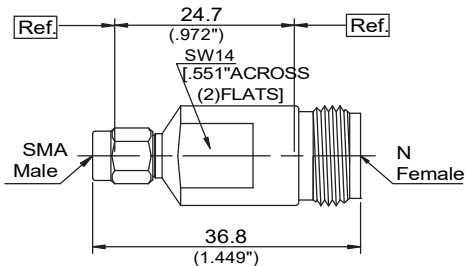

|        |                      |
|--------|----------------------|
| P/N    | DPA28025103          |
| Descr. | N Female to SMA Male |
| Freq.  | DC-18GHz             |
| VSWR   | 1.15:1(Max)          |

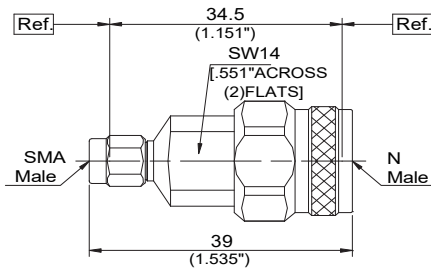

|        |                    |
|--------|--------------------|
| P/N    | DPA28125104        |
| Descr. | N Male to SMA Male |
| Freq.  | DC-18GHz           |
| VSWR   | 1.15:1(Max)        |

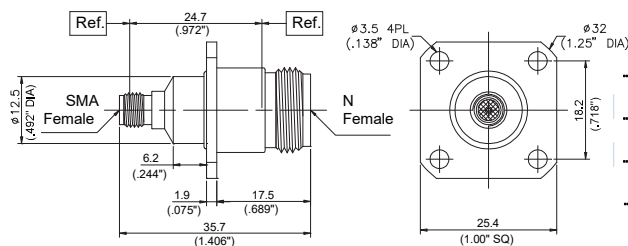

|        |                            |
|--------|----------------------------|
| P/N    | DPA28025005                |
| Descr. | N Male to SMA Male, Flange |
| Freq.  | DC-18GHz                   |
| VSWR   | 1.15:1(Max)                |

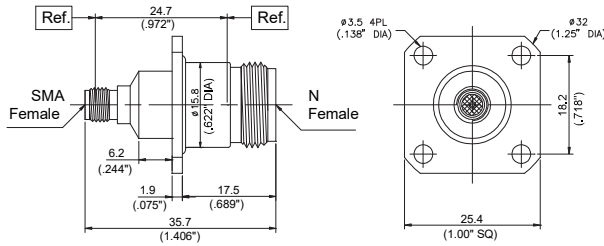

|        |                      |
|--------|----------------------|
| P/N    | DPA28025006          |
| Descr. | N F to SMA F, Flange |
| Freq.  | DC-18GHz             |
| VSWR   | 1.15:1(Max)          |

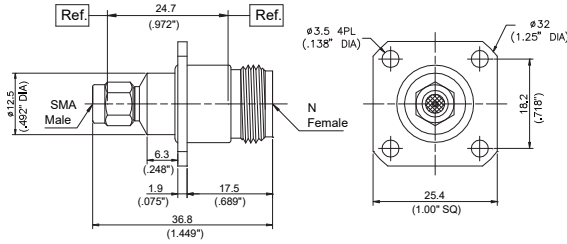

|        |                      |
|--------|----------------------|
| P/N    | DPA28025107          |
| Descr. | N F to SMA M, Flange |
| Freq.  | DC-18GHz             |
| VSWR   | 1.15:1(Max)          |

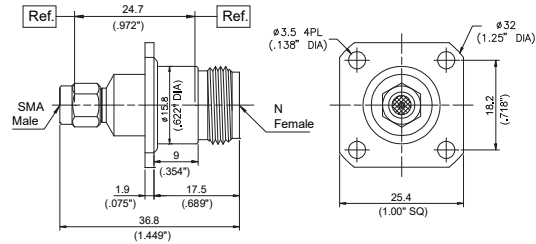

|        |                      |
|--------|----------------------|
| P/N    | DPA28025108          |
| Descr. | N F to SMA M, Flange |
| Freq.  | DC-18GHz             |
| VSWR   | 1.15:1(Max)          |

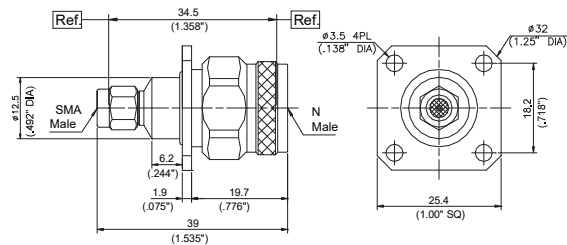

|        |                      |
|--------|----------------------|
| P/N    | DPA28025009          |
| Descr. | N F to SMA F, Flange |
| Freq.  | DC-18GHz             |
| VSWR   | 1.15:1(Max)          |

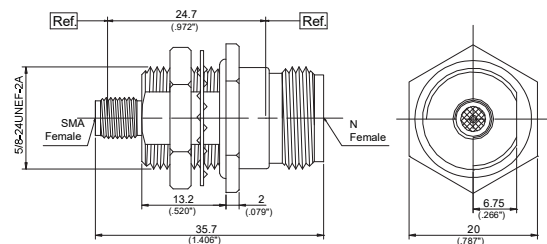

|        |                        |
|--------|------------------------|
| P/N    | DPA28025010            |
| Descr. | N F to SMA F, Bulkhead |
| Freq.  | DC-18GHz               |
| VSWR   | 1.15:1(Max)            |

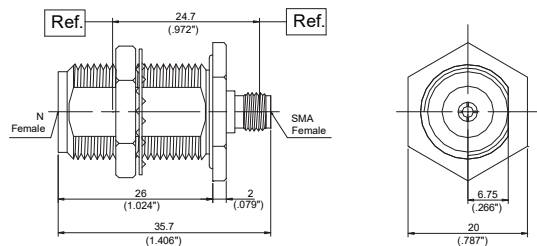

|        |                        |
|--------|------------------------|
| P/N    | DPA28025011            |
| Descr. | N F to SMA F, Bulkhead |
| Freq.  | DC-18GHz               |
| VSWR   | 1.15:1(Max)            |