

Performance Features

Nominal Impedance: 50Ω

Frequency Range: DC-27 GHz

Durability: 500 Cycles

Operating Temperature: -55°C~+165°C

Materials/Finishes

Housing: Type 303 Stainless Steel - Polished & Passivated

Center Contact: Beryllium Copper Plated Gold

Insulators: PEI&PTFE

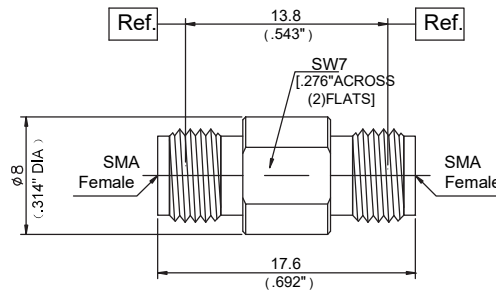

P/N	DPA25025001
Descr.	SMA Female to SMA Female
Freq.	DC-27GHz
VSWR	1.15:1(Max)

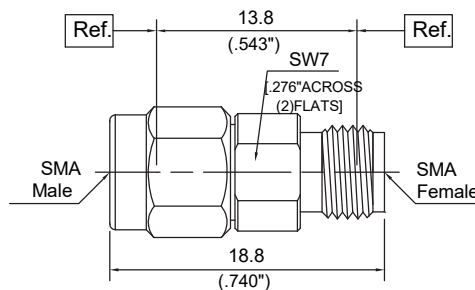

P/N	DPA25025102
Descr.	SMA Female to SMA Male
Freq.	DC-27GHz
VSWR	1.15:1(Max)

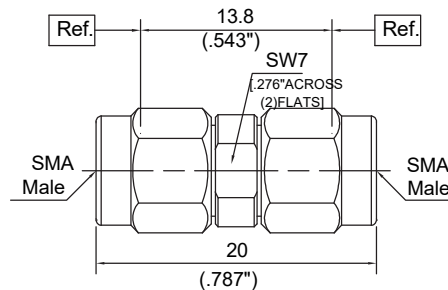

P/N	DPA25125103
Descr.	SMA Male to SMA Male
Freq.	DC-27GHz
VSWR	1.15:1(Max)

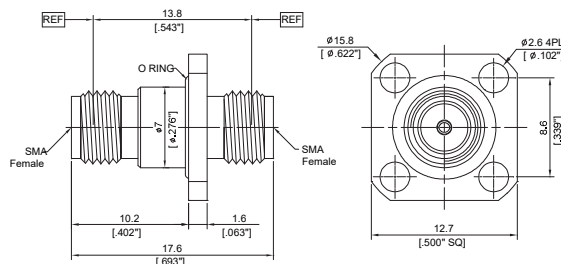
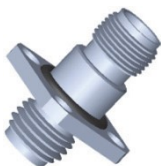

P/N	DPA25025004
Descr.	SMA F to SMA F, Flange
Freq.	DC-27GHz
VSWR	1.15:1(Max)

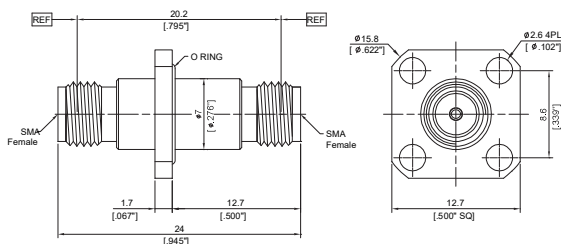

P/N	DPA25025005
Descr.	SMA F to SMA F, Flange
Freq.	DC-27GHz
VSWR	1.15:1(Max)

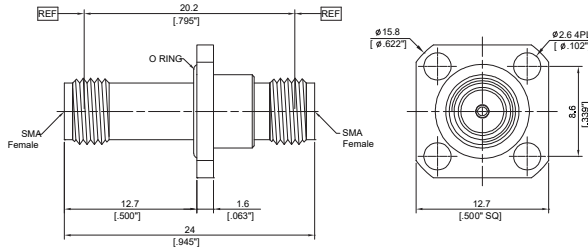

P/N	DPA25025006
Descr.	SMA F to SMA F, Flange
Freq.	DC-27GHz
VSWR	1.15:1(Max)

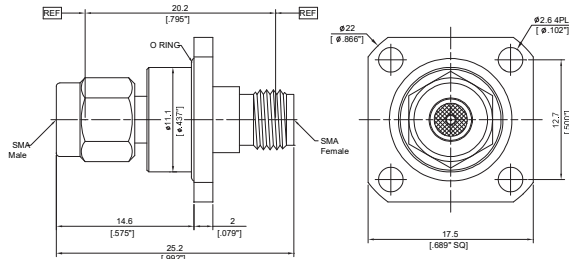

P/N	DPA25025107
Descr.	SMA F to SMA Male, Flange
Freq.	DC-27GHz
VSWR	1.15:1(Max)

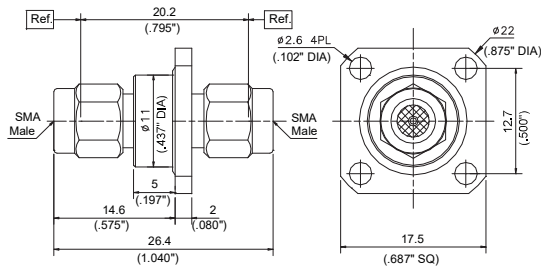

P/N	DPA25125108
Descr.	SMA M to SMA M, Flange
Freq.	DC-27GHz
VSWR	1.15:1(Max)

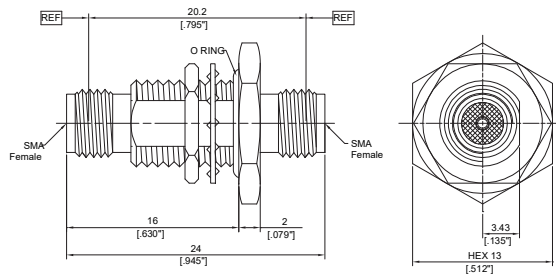

P/N	DPA25025009
Descr.	SMA F to SMA F, Bulkhead
Freq.	DC-27GHz
VSWR	1.15:1(Max)

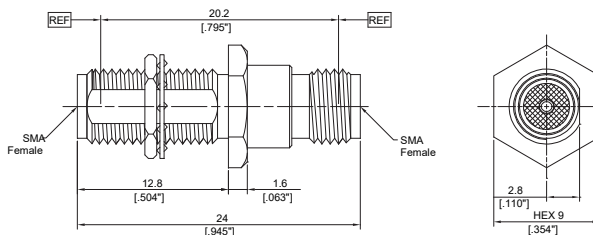

P/N	DPA25025010
Descr.	SMA F to SMA F, Bulkhead
Freq.	DC-27GHz
VSWR	1.15:1(Max)

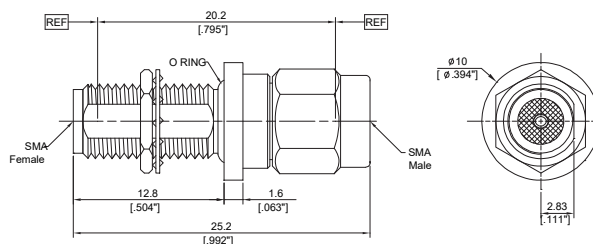

P/N	DPA25025111
Descr.	SMA F to SMA M, Bulkhead
Freq.	DC-27GHz
VSWR	1.15:1(Max)

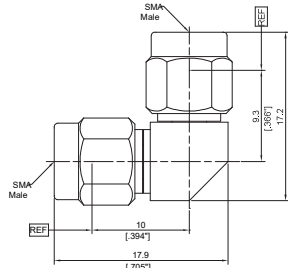

P/N	DPA25125112
Descr.	SMA Male RA to SMA Male
Freq.	DC-27GHz
VSWR	1.25:1(Max)

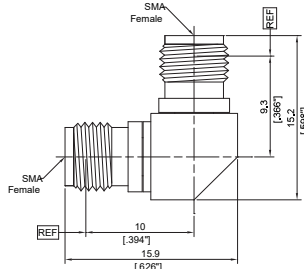

P/N	DPA25025013
Descr.	SMA F RA to SMA F
Freq.	DC-27GHz
VSWR	1.25:1(Max)

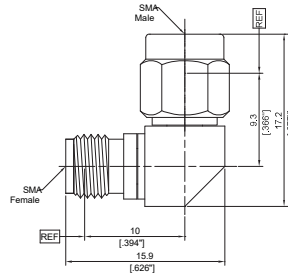

P/N	DPA25025114
Descr.	SMA Female RA to SMA Male
Freq.	DC-27GHz
VSWR	1.25:1(Max)