

Performance Features

Nominal Impedance: 50Ω

Durability: 500 Cycles

Operating Temperature: -55°C~+125°C

Materials/Finishes

Housing: Type 303 Stainless Steel - Polished & Passivated

Center Contact: Beryllium Copper Plated Gold

Insulators: PEI/PTFE

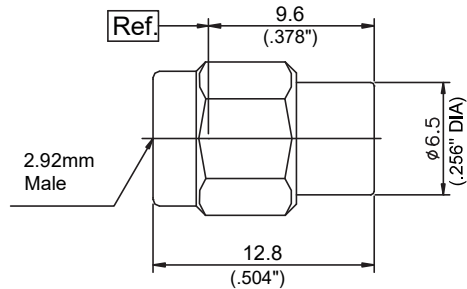

P/N	DPT231-0.5
Descr.	2.92mm Male Termination
Freq.	DC-40GHz
VSWR	1.20:1(Max)
Power	0.5W

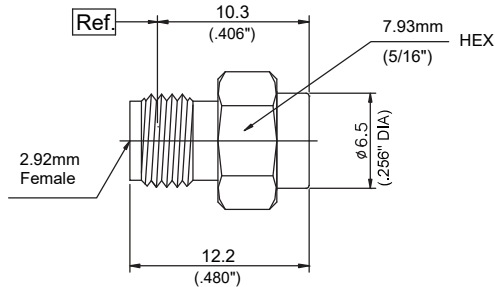

P/N	DPT230-0.5
Descr.	2.92mm Female Termination
Freq.	DC-40GHz
VSWR	1.20:1(Max)
Power	0.5W

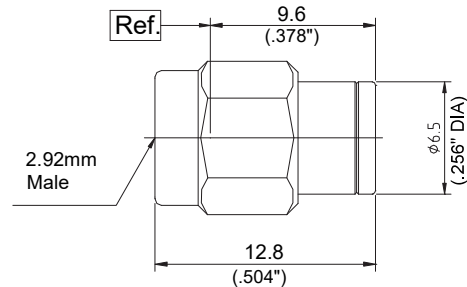

P/N	DPT231-1
Descr.	2.92mm Male Termination
Freq.	DC-40GHz
VSWR	1.25:1(Max)
Power	1W

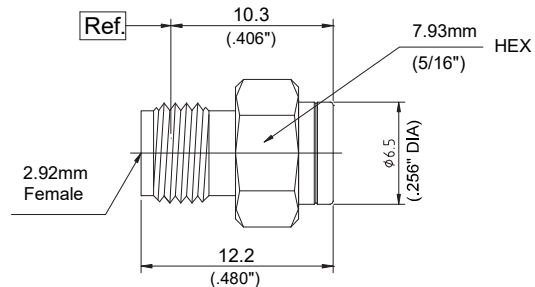

P/N	DPT230-1
Descr.	2.92mm Female Termination
Freq.	DC-40GHz
VSWR	1.25:1(Max)
Power	1W