

Performance Features

Nominal Impedance: 50Ω

Durability: 500 Cycles

Operating Temperature: -55°C~+125°C

Materials/Finishes

Housing: Type 303 Stainless Steel - Polished & Passivated

Center Contact: Beryllium Copper Plated Gold

Insulators: PEI/PTFE

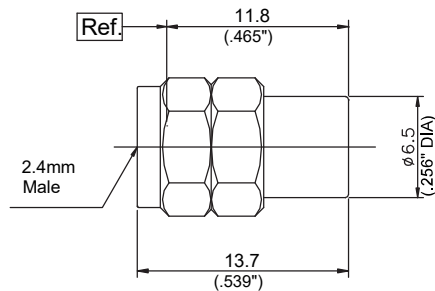

P/N	DPT221-40-0.5
Descr.	2.4mm Male Termination
Freq.	DC-40GHz
VSWR	1.25:1(Max)
Power	0.5W

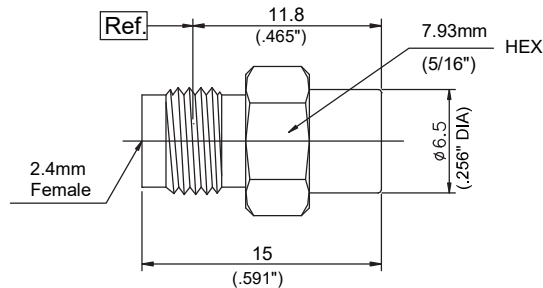

P/N	DPT220-40-0.5
Descr.	2.4mm Female Termination
Freq.	DC-40GHz
VSWR	1.25:1(Max)
Power	0.5W

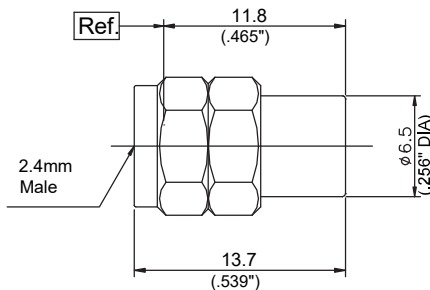

P/N	DPT221-50-0.5
Descr.	2.4mm Male Termination
Freq.	DC-50GHz
VSWR	1.35:1(Max)
Power	0.5W

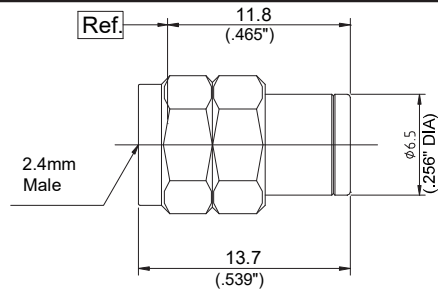

P/N	DPT221-40-1
Descr.	2.4mm Male Termination
Freq.	DC-40GHz
VSWR	1.30:1(Max)
Power	1W

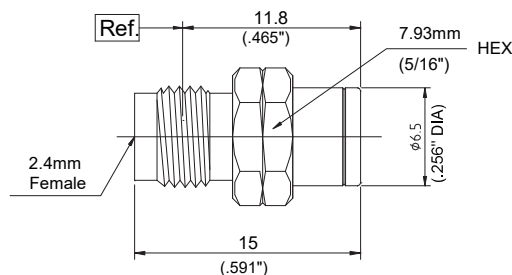

P/N	DPT220-40-1
Descr.	2.4mm Female Termination
Freq.	DC-40GHz
VSWR	1.30:1(Max)
Power	1W

Performance Features

Nominal Impedance: 50Ω

Durability: 500 Cycles

Operating Temperature: -55°C~+125°C

Materials/Finishes

Housing: Type 303 Stainless Steel - Polished & Passivated

Center Contact: Beryllium Copper Plated Gold

Insulators: PEI/PTFE

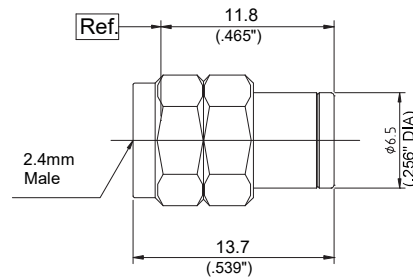

P/N DPT221-50-1

Descr. 2.4mm Male Termination

Freq. DC-50GHz

VSWR 1.35:1(Max)

Power 1W

Performance Features

Nominal Impedance: 50Ω

Durability: 500 Cycles

Operating Temperature: -55°C~+125°C

Materials/Finishes

Housing: Type 303 Stainless Steel - Polished & Passivated

Center Contact: Beryllium Copper Plated Gold

Insulators: PEI/PTFE

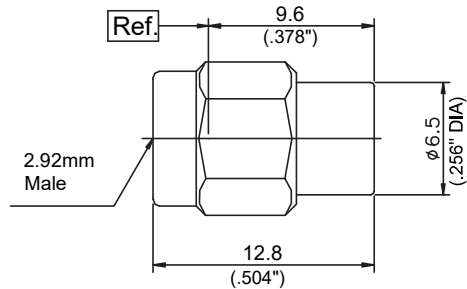

P/N	DPT231-0.5
Descr.	2.92mm Male Termination
Freq.	DC-40GHz
VSWR	1.20:1(Max)
Power	0.5W

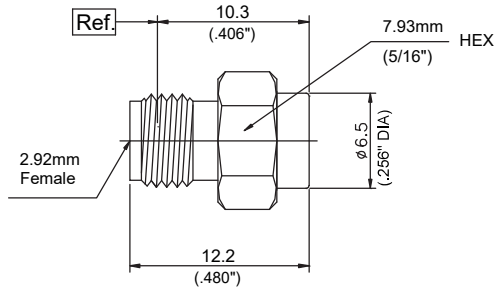

P/N	DPT230-0.5
Descr.	2.92mm Female Termination
Freq.	DC-40GHz
VSWR	1.20:1(Max)
Power	0.5W

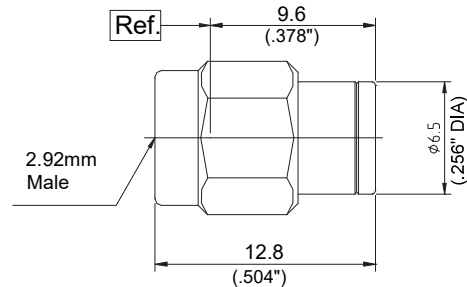

P/N	DPT231-1
Descr.	2.92mm Male Termination
Freq.	DC-40GHz
VSWR	1.25:1(Max)
Power	1W

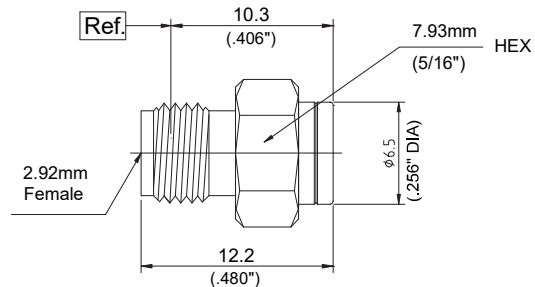

P/N	DPT230-1
Descr.	2.92mm Female Termination
Freq.	DC-40GHz
VSWR	1.25:1(Max)
Power	1W

Performance Features

Nominal Impedance: 50Ω

Durability: 500 Cycles

Operating Temperature: -55°C~+125°C

Materials/Finishes

Housing: Type 303 Stainless Steel - Polished & Passivated

Center Contact: Beryllium Copper Plated Gold

Insulators: PEI/PTFE

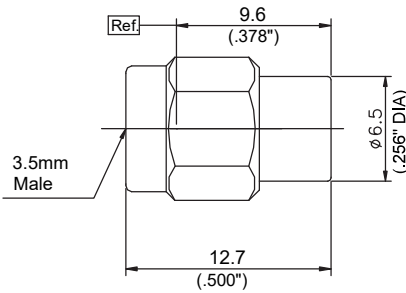
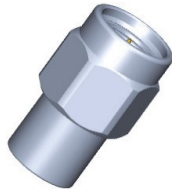

P/N	DPT241-27-1
Descr.	3.5mm Male Termination
Freq.	DC-27GHz
VSWR	1.15:1(Max)
Power	1W

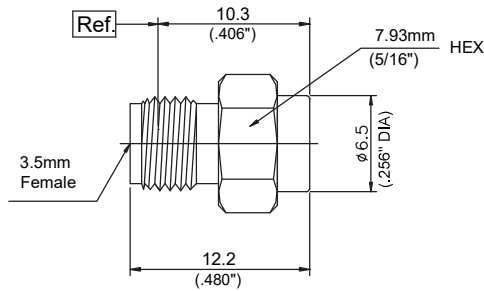

P/N	DPT240-27-1
Descr.	3.5mm Female Termination
Freq.	DC-27GHz
VSWR	1.15:1(Max)
Power	1W

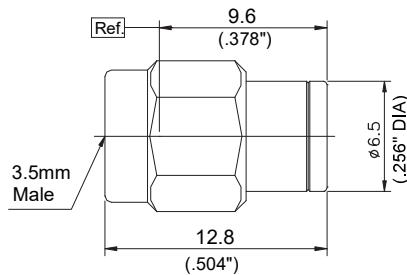

P/N	DPT241-27-2
Descr.	3.5mm Male Termination
Freq.	DC-27GHz
VSWR	1.20:1(Max)
Power	2W

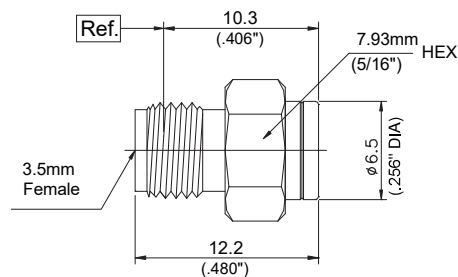

P/N	DPT240-27-2
Descr.	3.5mm Male Termination
Freq.	DC-27GHz
VSWR	1.20:1(Max)
Power	2W

Performance Features

Nominal Impedance: 50Ω

Durability: 500 Cycles

Operating Temperature: -55°C~+125°C

Materials/Finishes

Housing: Type 303 Stainless Steel - Polished & Passivated

Center Contact: Beryllium Copper Plated Gold

Insulators: PEI/PTFE

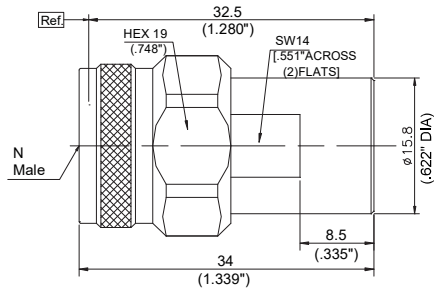

P/N	DPT281-18-2
Descr.	N Male Termination
Freq.	DC-18GHz
VSWR	1.15:1(Max)
Power	2W

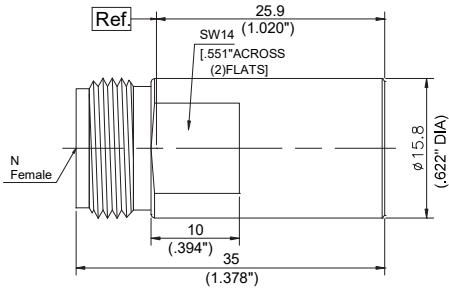

P/N	DPT280-18-2
Descr.	N Female Termination
Freq.	DC-18GHz
VSWR	1.15:1(Max)
Power	2W

Performance Features

Nominal Impedance: 50Ω

Durability: 500 Cycles

Operating Temperature: -55°C~+125°C

Materials/Finishes

Housing: Type 303 Stainless Steel - Polished & Passivated

Center Contact: Beryllium Copper Plated Gold

Insulators: PEI/PTFE

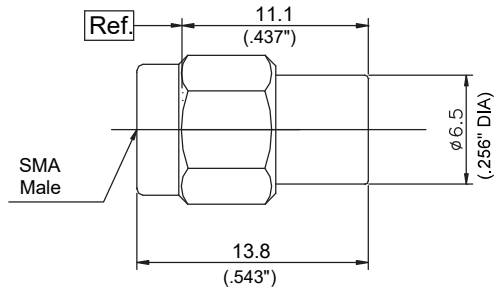

P/N	DPT251-18-1
Descr.	SMA Male Termination
Freq.	DC-18GHz
VSWR	1.15:1(Max)
Power	1W

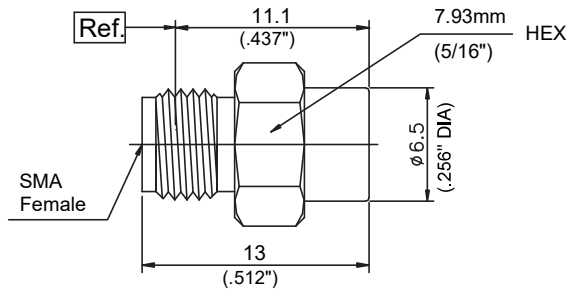

P/N	DPT250-18-1
Descr.	SMA Female Termination
Freq.	DC-18GHz
VSWR	1.15:1(Max)
Power	1W

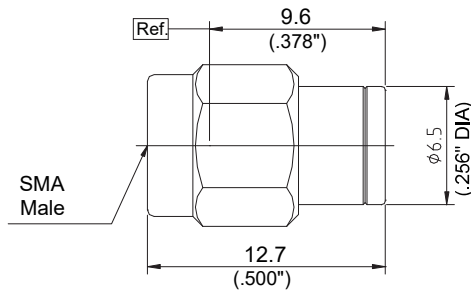

P/N	DPT251-18-2
Descr.	SMA Male Termination
Freq.	DC-18GHz
VSWR	1.20:1(Max)
Power	2W

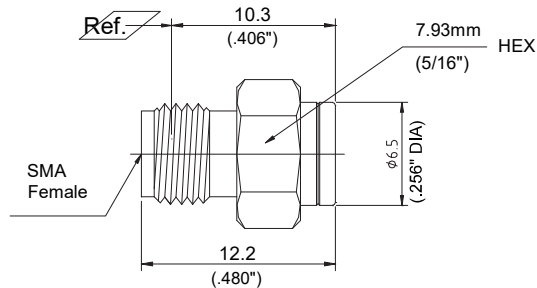

P/N	DPT250-18-2
Descr.	SMA Female Termination
Freq.	DC-18GHz
VSWR	1.20:1(Max)
Power	2W