

Revisions			
Rev	Description	Date	Approved:
A	Initial Release	2019.6.10	A. M

### ELECTRICAL SPECIFICATIONS

Frequency Range: 6.57-9.99 GHz

VSWR: 1.25 max.

### MATERIAL

Waveguide Body: Aluminum

#### SMA Female

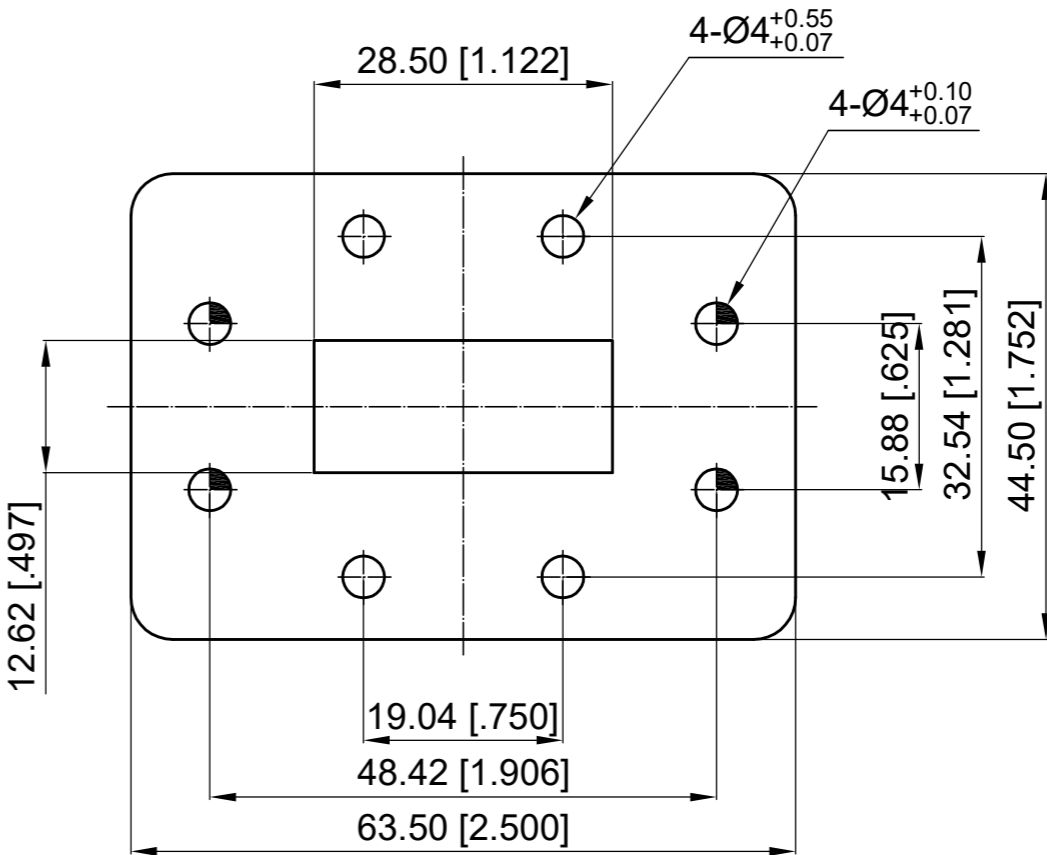
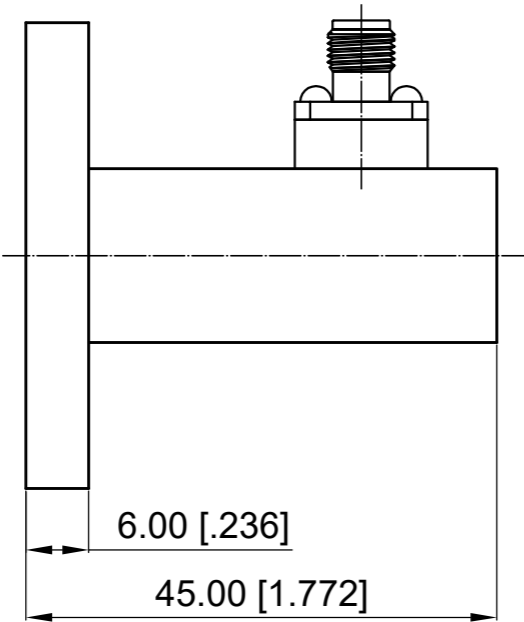

A

#### NOTES:

- 1. ALL SPECIFICATIONS ARE SUBJECT TO CHANGE WITHOUT NOTICE AT ANY TIME
- 2. CUSTOMER OUTLINE DRAWING FOR REFERENCE ONLY

Drawn:	W. Y 2021.5.21
Checked:	T. L 2021.5.21
Approved:	A. M 2021.5.21
Unless Otherwise Specified Dimensions are in Millimeters, Dimensions in [ ] are in Inches for Customer Reference Only. Unless Otherwise Specified Tolerance are: .XX ±0.13 [.005"] .X ±0.20 [.008"] X ±0.50 [.019"] .X° ±1° X° ±2°	

Title:	WR112 (UDR84) Right Angle to SMA Female Adaptor, Freq 6.57-9.99 GHz
Part No:	DWCA112D1SFL



View:	
Size:	A3
Scale:	1:1
Sheet:	1/1
Rev:	A

Revisions

Rev	Description	Date	Approved:
A	Initial Release	2017.5.24	A. M

**ELECTRICAL SPECIFICATIONS**

Frequency Range: 6.57-9.99 GHz

VSWR: 1.25 max.

**MATERIAL**

Waveguide Body: Aluminum

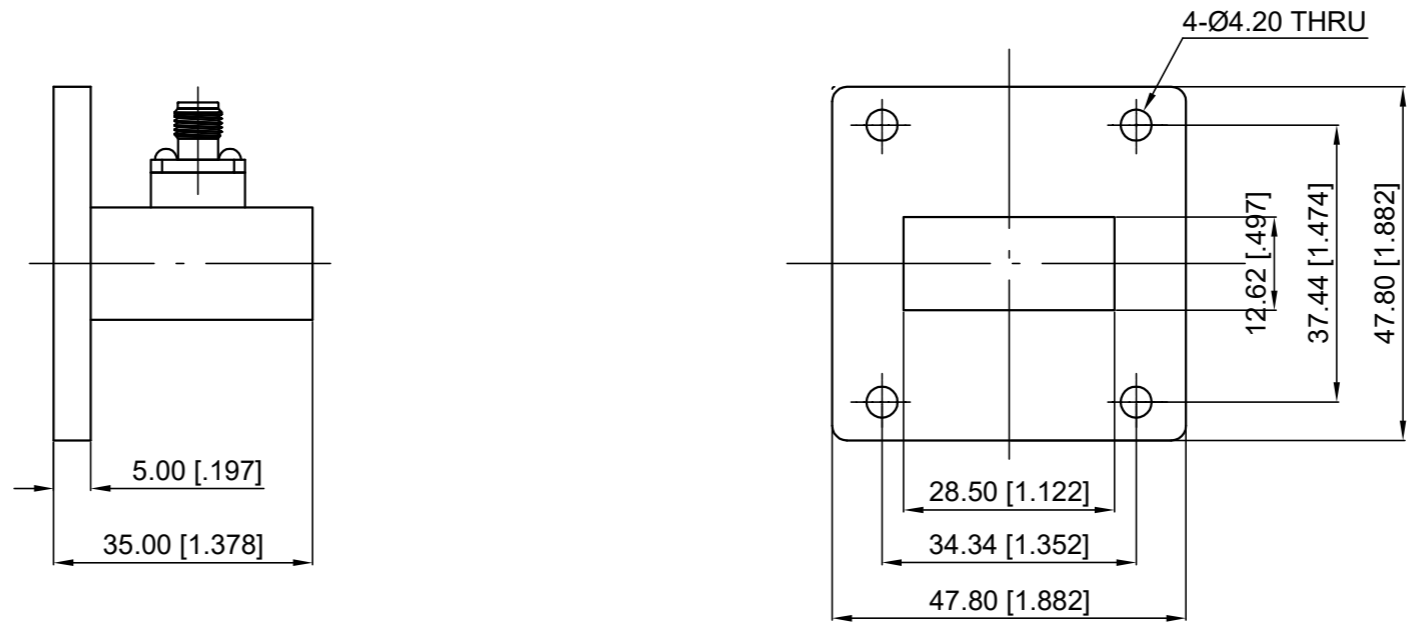

- NOTES:
1. ALL SPECIFICATIONS ARE SUBJECT TO CHANGE WITHOUT NOTICE AT ANY TIME
  2. CUSTOMER OUTLINE DRAWING FOR REFERENCE ONLY

Drawn:	W. Y 2017.5.24
Checked:	T. L 2017.5.24
Approved:	A. M 2017.5.24
Unless Otherwise Specified Dimensions are in Millimeters, Dimensions in [ ] are in Inches for Customer Reference Only. Unless Otherwise Specified Tolerance are: .XX ±0.13 [.005"] .X ±0.20 [.008"] X ±0.50 [.019"] .X° ±1° X° ±2°	

Title:	WR112 (UBR84) Right Angle to SMA Female Adaptor, Freq 6.57-9.99 GHz
Part No:	DWCA112B1SFL



View:	
Size:	A3
Scale:	1:1
Sheet:	1/1
Rev:	A