

ELECTRICAL SPECIFICATIONS

- 1. Frequency Range: 11.9-18 GHz
- 2. VSWR: 1.25 max.

MATERIAL

- 1. Body: Brass, Ag Plated
- 2. Paint: Gray

Revisions			
Rev	Description	Date	Approved:
A	Initial Release	2017.8.2	A. M
B	Material Updated	2021.10.4	A. M

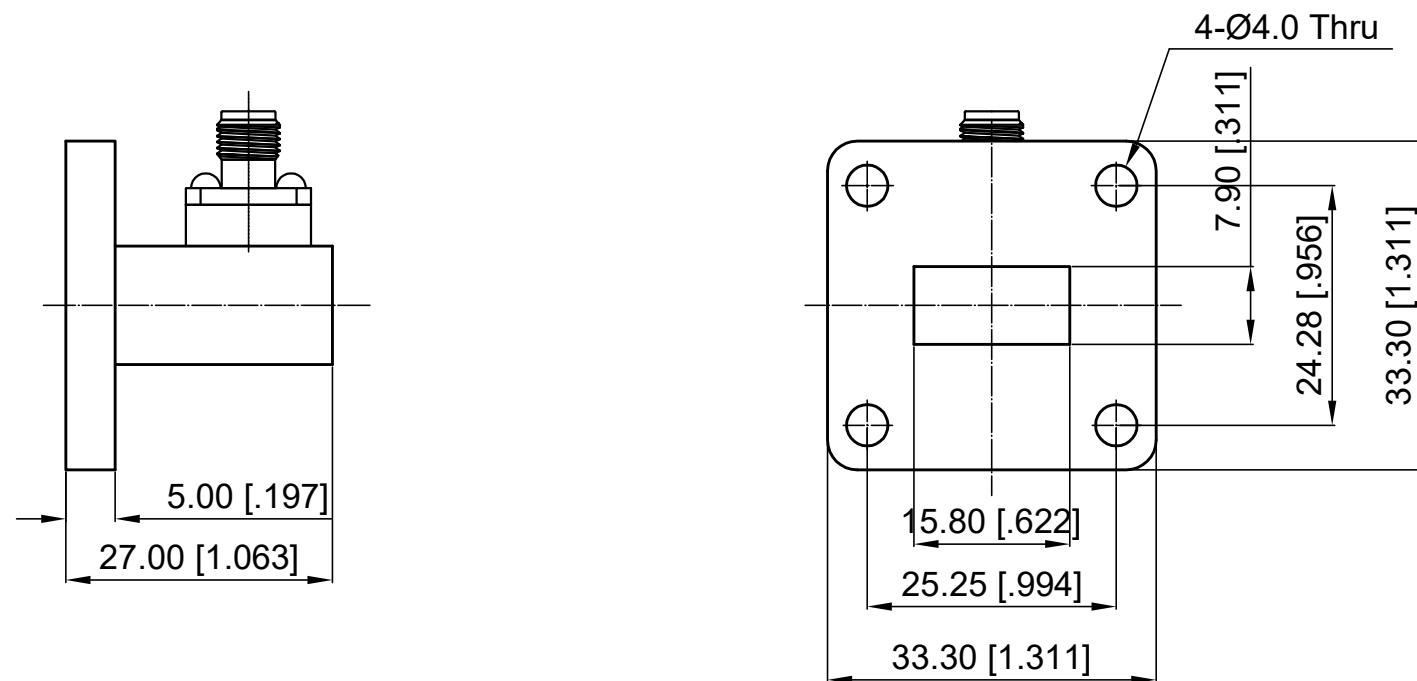

NOTES:

- 1. ALL SPECIFICATIONS ARE SUBJECT TO CHANGE WITHOUT NOTICE AT ANY TIME
- 2. CUSTOMER OUTLINE DRAWING FOR REFERENCE ONLY

Drawn:	W. Y 2021.10.4
Checked:	T. L 2021.10.4
Approved:	A. M 2021.10.4
Unless Otherwise Specified Dimensions are in Millimeters, Dimensions in [] are in Inches for Customer Reference Only. Unless Otherwise Specified Tolerance are: .XX ±0.13 [.005"] .X ±0.20 [.008"] X ±0.50 [.019"] .X° ±1° X° ±2°	

Title:	WR62 (UBR140) Right Angle to SMA Female Adaptor, Freq 11.9-18 GHz
Part No:	DWCA62SFL

DEEWAVE
www.deewave.com

View:

Size: A3	Scale: 1.5:1	Sheet: 1/1	Rev: B
----------	--------------	------------	--------